

# QMCR Freshers' Week

27 September - 10 October 2018

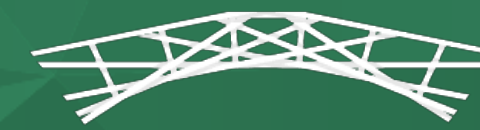

QUEENS' COLLEGE  
CAMBRIDGE

MONDAY	TUESDAY	WEDNESDAY	THURSDAY	FRIDAY	SATURDAY	SUNDAY																						
24 Sep	25 Sep	26 Sep	27 Sep	28 Sep	29 Sep	30 Sep																						
	<p><b>17:00 @ Woodville Room</b> Welcome drinks for early arrivers. <i>If you are arriving early, then join us for some casual drinks in the MCR, followed by dinner in Cripps Hall. We will then go to The Eagle, one of Cambridge's famous pubs, leaving from the Plodge at 19:00.</i></p>		<p><i>Most graduates will arrive on this day. If you're moving into a college house or main site room, collect your room keys and university card from the College Porters' Lodge (Plodge) in Silver Street. If you're moving into Owlstone Croft collect your room key and university card from Owlstone Porters' Lodge. If you're moving into private accommodation you'll still need to collect your university card from the College Plodge.</i></p> <p><b>12:00 - 16:00 @ Armitage Room (FF)</b> New Student Registration: passport, visa and ID document scanning</p> <p><b>17:00 @ Woodville Room</b> Tea &amp; biscuits</p> <p><b>19:00</b> Visit to the Anchor Pub, leave from the Plodge</p>	<p><b>10:00 - 12:30 @ Armitage Room (FF)</b> New Student Registration: passport, visa and ID document scanning</p> <p><b>12:00 @ QBar</b> Graduate Tutors Welcome Lunch Buffet</p> <p><b>13:00 @ Fitzpatrick Hall</b> Tutors and staff welcome presentation</p> <p><b>14:15 @ President's Lodge</b> Signing of matriculation register</p> <p><b>15:00 @ President's Garden</b> Afternoon tea (@ Old Hall if bad weather)</p> <p><b>20:00 @ Old Hall</b> ☒ MCR welcome reception</p>	<p><b>11:00 - 13:30 @ QBar</b> Grad Buddies meet up.</p> <p><b>13:30 - 14:15</b> College tour with Joe Stallard, convene at the Mathematical Bridge</p> <p><b>14:15 - 15:00</b> Practical Cambridge tour with Juan Canavera, meet at Old Gate</p> <p><b>15:00 - 18:00 @ Woodville Room</b> Punting and Tea &amp; scones</p> <p><b>19:30 @ Qbar</b> MCR quiz night with Hugo Hadfield and Piet Lammers</p> <p><b>23:00</b> Cambridge night out, leave from QBar</p>	<p><b>10:00 - 11:00 @ Owlstone Croft Gate</b> MCR run club</p> <p><b>11:00 - 13:30 @ Cripps Hall</b> Buttery brunch</p> <p><b>11:00 - 13:00 @ Erasmus Lawn</b> Portraits photo</p> <p><b>13:30 @ Walnut Tree Court</b> ☒ Matriculation photo</p> <p><b>14:00 @ Cripps Hall</b> Mixer event, followed by a scavenger hunt throughout the college.</p> <p><b>16:00pm @ Old Hall &amp; Old Kitchens</b> Subject cluster groups meetup with refreshments</p> <p><b>19:00 @ Woodville Room</b> Welfare tea by Elizabeth Weir, followed by a film screening (19:45 start, 90min) in the <b>Fitzpatrick hall</b>, Pizza will be provided.</p>																						
1 Oct	2 Oct	3 Oct	4 Oct	5 Oct	6 Oct	7 Oct																						
<p><b>10:00 or 14:00 @ College Library</b> Graduate library tours, drop in sessions</p> <p><b>14:30 - 15:30 @ Fitzpatrick Hall</b> Boatie squash</p> <p><b>15:30 - 18:00 @ Lyon Court &amp; Qbar</b> Queens' societies squash</p> <p><b>19:00 @ Cripps Court CC43</b> Intro to Cambridge Library System (libraries/e-resources &amp; special collections) with the College Librarian. Drop in session.</p> <p><b>20:00 @ Owlstone Croft</b> Owlstone Croft BBQ <i>For those who do not live in Owlstone Croft: it is a Queens' owned graduate accommodation block on the banks of the Cam, 15 minutes walk from the main site.</i></p>	<p><b>15:00 @ Cripps Court CC43</b> Intro to Cambridge Library System (libraries/e-resources &amp; special collections) with the College Librarian. Drop in session.</p> <p><b>18:45 @ Fitz, Cripps &amp; Old Hall</b> ☒ Matriculation Dinner <i>The Matriculation dinner is free, and you will be sitting close to students and fellows in similar subjects. Drinks are served in the Fitzpatrick hall at 18:45, the dinner itself is immediately after that in Cripps hall and Old Hall (depending on course). Dress code is as for the matriculation photo, including gowns.</i></p>	<p><b>10:00 or 11:00</b> Freshers' fair at Parker's Piece, meet at the plodge at 10:00 or 11:00. <i>The Fresher's fair is a huge event at parker's piece where many university-wide committees and university sports clubs display themselves. A great way to explore what extracurriculars to take on during your time in Cambridge. We will leave in two groups, at 10:00 and 11:00.</i></p> <p><b>17:00 @ Woodville Room</b> Tea tasting</p> <p><b>20:00</b> Cambridge pub crawl. Meet at QBar.</p>	<p><b>19:00 @ Cripps Hall</b> ☒ MCR Formal Hall Booking opens on 1st Oct <i>Formals are organised weekly during term time, alternating between Tuesday and Thursday. These are Cambridge's signature events to socialise and meet new people - throughout the whole year, not just in freshers' week. Dress code is formal with gowns, and booking via UPAY.</i></p>	<p><b>20:00 @ Woodville Room</b> MCR Party <i>MCR parties tend to be very, very nice and casual events. The ideal evening path after that leads into Spoons - regarded the most illustrious club in Cambridge.</i></p>	<p><b>14:00 - 18:00</b> Visit to Grantchester, meet at the Plodge. <i>After brunch, join us for a walk to the lovely village of Grantchester with its famous tea room and orchard where we will enjoy afternoon tea and with scones or cakes.</i></p> <p><b>18:00</b> Queens' Graduate Choir Concert</p> <p><b>19:00 @ Jesus &amp; Queens' College</b> 🇺🇦 Pizza at Jesus College with Jesus LGBTQ+, meet up directly at Jesus College Plodge. Drinks in the Woodville room from 8pm.</p>	<p><b>10:00 - 12:00 @ Lyon Court</b> First MCR squash initiation</p> <p><b>14:00 - 15:30 @ Woodville Room</b> PhD(freshers or continuing) meet-up with tea, coffee and scones.</p> <p><b>15:30</b> Critical Walking Tour led by Tobias, Ankita, Susie &amp; Mansoor, leaving from the Plodge.</p> <p><b>18:00 @ Queens' Chapel (Gown Required)</b> Choral evensong &amp; reception with the Dean of chapel.</p> <p><b>20:00 @ Old Hall (Sign-up required)</b> ☒ Wine &amp; Cheese night</p>																						
8 Oct	9 Oct	10 Oct	<p><b>Queens' College Library induction, in the Queens' College Library</b> From Mon 1 Oct to Thu 4 Oct 10:00 and 14:00</p> <p><b>Using the Cambridge library system, in Room CC43</b></p> <p>Mon 1 Oct 19:00 Tue 2 Oct 15:00 Wed 3 Oct 15:00</p>			<p><b>Cafeteria opening times (Cripps Dinning Hall)</b></p> <p><b>Term time</b></p> <table> <tr> <td>Breakfast</td> <td>08:15 - 09:30</td> <td>Monday - Friday</td> </tr> <tr> <td>Lunch</td> <td>12:30 - 14:00</td> <td>Monday - Friday</td> </tr> <tr> <td>Brunch</td> <td>11:00 - 13:30</td> <td>Saturday &amp; Sunday</td> </tr> <tr> <td>Dinner</td> <td>17.45 - 19:00</td> <td>everyday</td> </tr> </table> <p><b>Out of term</b></p> <table> <tr> <td>Breakfast</td> <td>08:30 - 09:30</td> <td>everyday</td> </tr> <tr> <td>Lunch</td> <td>12:30 - 13:30</td> <td>everyday</td> </tr> <tr> <td>Dinner</td> <td>18:00 - 19:00</td> <td>everyday</td> </tr> </table>		Breakfast	08:15 - 09:30	Monday - Friday	Lunch	12:30 - 14:00	Monday - Friday	Brunch	11:00 - 13:30	Saturday & Sunday	Dinner	17.45 - 19:00	everyday	Breakfast	08:30 - 09:30	everyday	Lunch	12:30 - 13:30	everyday	Dinner	18:00 - 19:00	everyday
Breakfast	08:15 - 09:30	Monday - Friday																										
Lunch	12:30 - 14:00	Monday - Friday																										
Brunch	11:00 - 13:30	Saturday & Sunday																										
Dinner	17.45 - 19:00	everyday																										
Breakfast	08:30 - 09:30	everyday																										
Lunch	12:30 - 13:30	everyday																										
Dinner	18:00 - 19:00	everyday																										
<p><b>18:30 @ President's Lodge</b> First President's Lodge visit <i>You will be contacted directly by the President's Secretary to arrange a visit.</i></p>	<p><b>18:30 @ President's Lodge</b> Second President's Lodge visit</p>	<p><b>13:30</b> Doug Dennis' historical tour of Cambridge</p>																										

**Mandatory events.** Dress code: ☒ Suit & tie or equivalent(no gown required); ☒ Suit & tie or equivalent, gown required.

If in doubt, please contact Yudi Ding ([mcr-secretary@queens.cam.ac.uk](mailto:mcr-secretary@queens.cam.ac.uk)).